

Service

Name	COMO
Typ	T 05 - HIGHBOARD

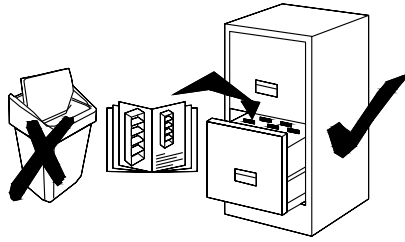

- ① 1232×379×19
- ② 1232×379×19
- ③ 1232×379×19
- ④ 1232×379×19
- ⑤ 642×376×19
- ⑤a 384×146×4
- ⑥ 642×376×19
- ⑥a 384×146×4
- ⑦ 642×376×19
- ⑧ 642×376×19
- ⑨ 630×170×19
- ⑩ 630×335×18
- ⑪ 575×300×6
- ⑫ 584×300×18
- ⑬a 596×160×20
- ⑬b 596×160×20
- ⑭a 596×160×20
- ⑭b 596×160×20
- ⑮ 384×592×4
- ⑯ 636×596×20
- ⑰ 636×596×20
- ⑱ 1148×337×25
- ⑲ 646×1206×3
- ⑳ 646×1206×3
- ㉑ 60×60×15
- ㉒ 1172×413×10 **Beleuchtung!!**

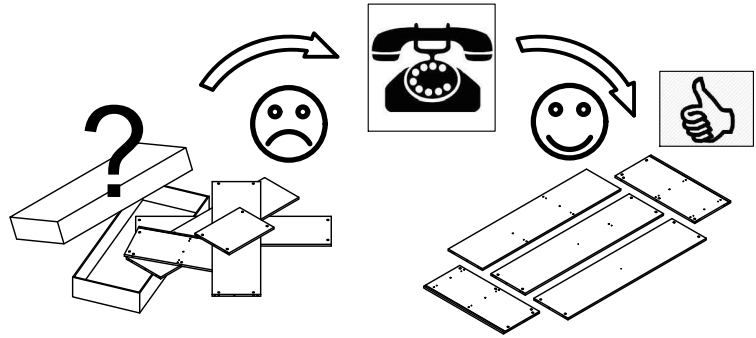
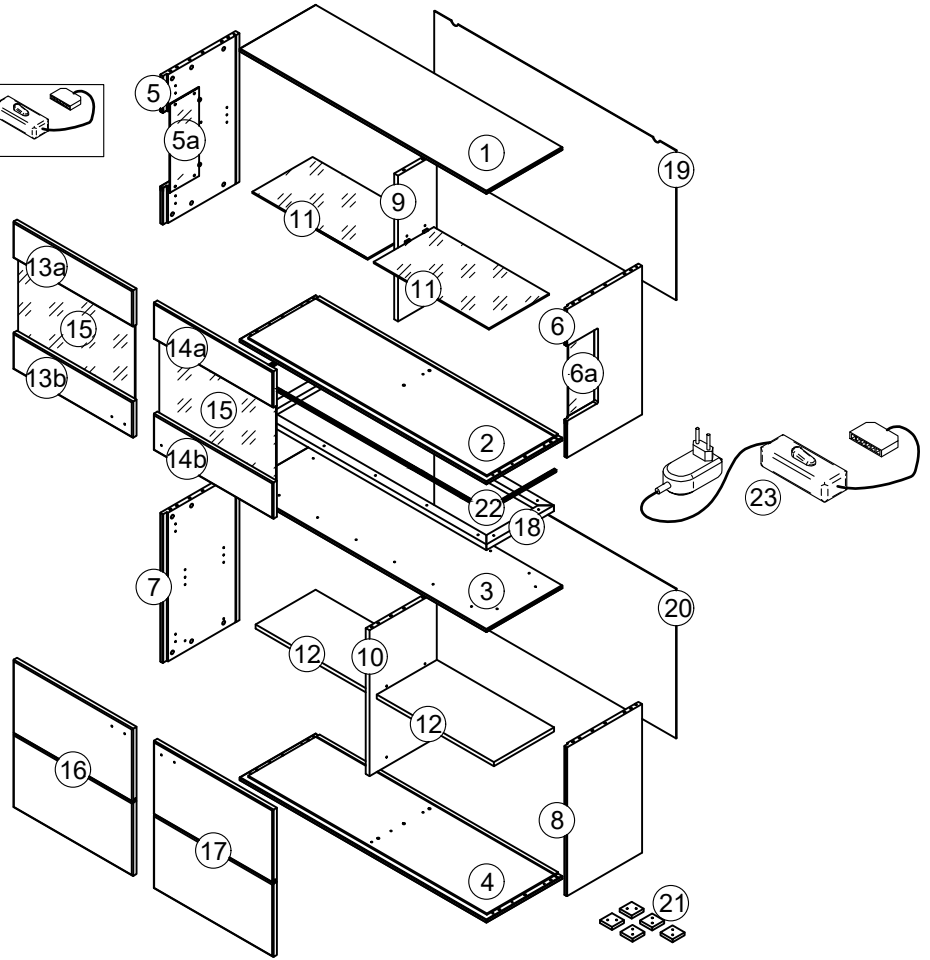
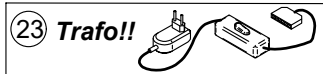

OPTION		
05062ZB_Trafo	05062ZB_LED	005091ZB
x1	x1	x1

D1 Ø8x32 mm 	S1-20 3,0x20 mm 	S2-35 4,0x35 mm 	H2 9mm 	X 	ST
EX1 Ø15x12 mm 	S-16 3,5x16 mm 	ES 6,3x13 mm 	P2 3mm 	C2 	PG mat black 64 mm
T1 	S2-16L 4x16 mm 	B 	GL 	W1 	M25 M4x25 mm
S1-16 3,0x16 mm 	S2-30 4,0x30 mm 	TC 	B7 Ø7/9x5mm 	W4 	A3 77x20x15 mm

Modellname: **COMO**

MONTAGEANLEITUNG

TYPE T05 - HIGHBOARD

1/4

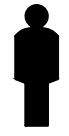

2 Person

20
Min.

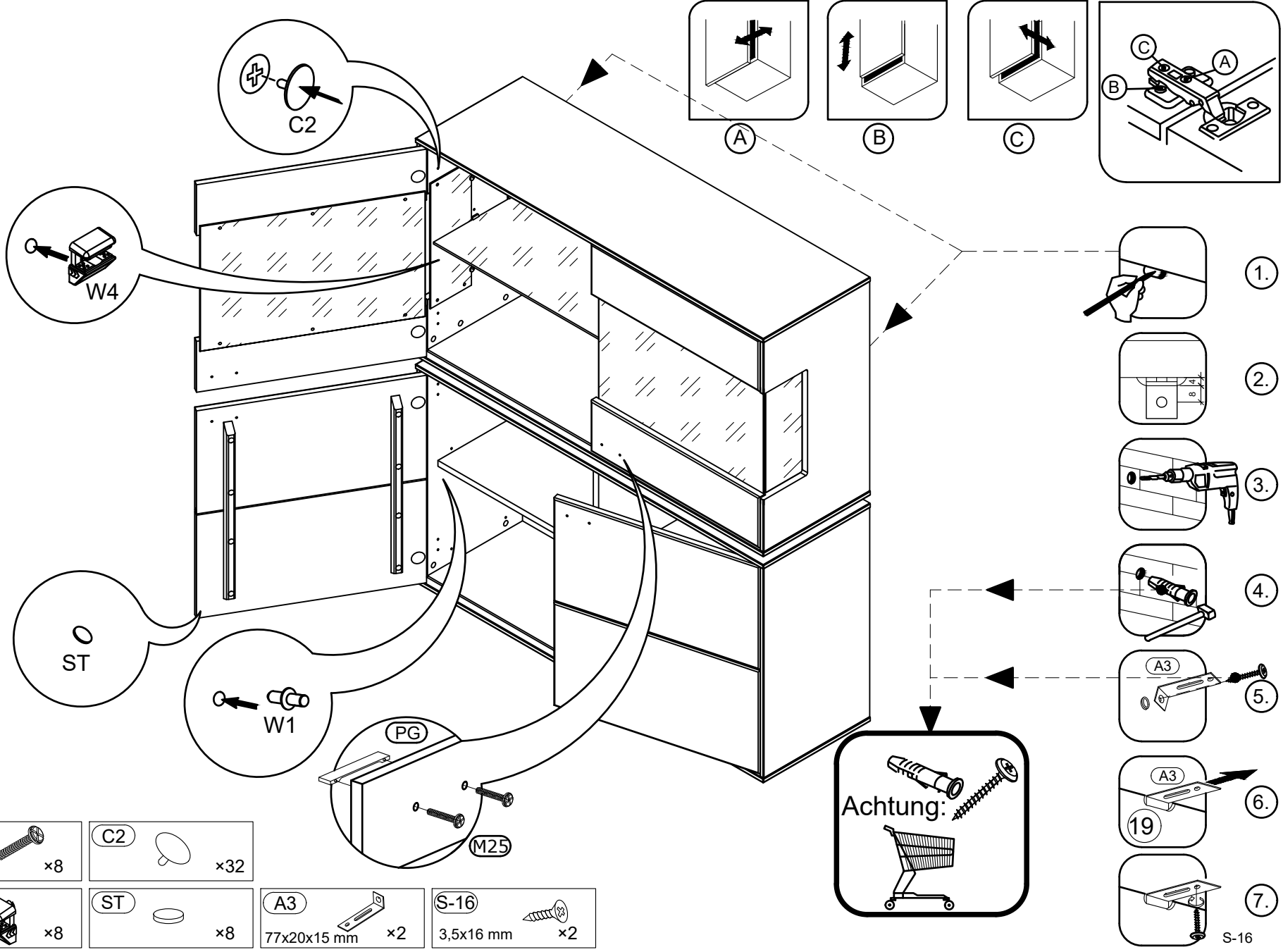
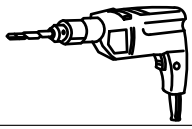
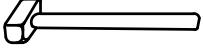
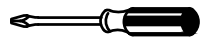

PG	<i>mat black</i>
64 mm	x4

M25		x8
M4x25 mm		

C2		x32
-----------	--	-----

W1		x8
-----------	--	----

W4		x8
-----------	--	----

ST		x8
-----------	--	----

A3		x2
77x20x15 mm		

S-16		x2
3,5x16 mm		

Achtung:

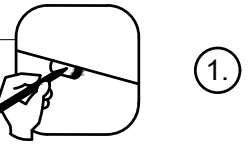

1.

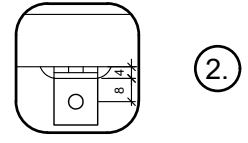

2.

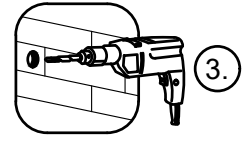

3.

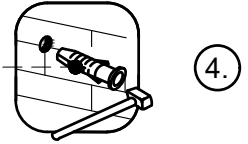

4.

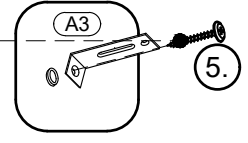

5.

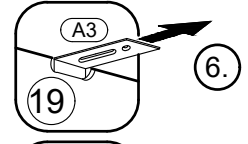

6.

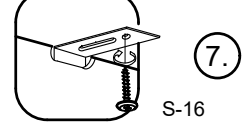

7.

S-16

Modellname: **COMO**

MONTAGEANLEITUNG

TYPE T05 - HIGHBOARD

2/4

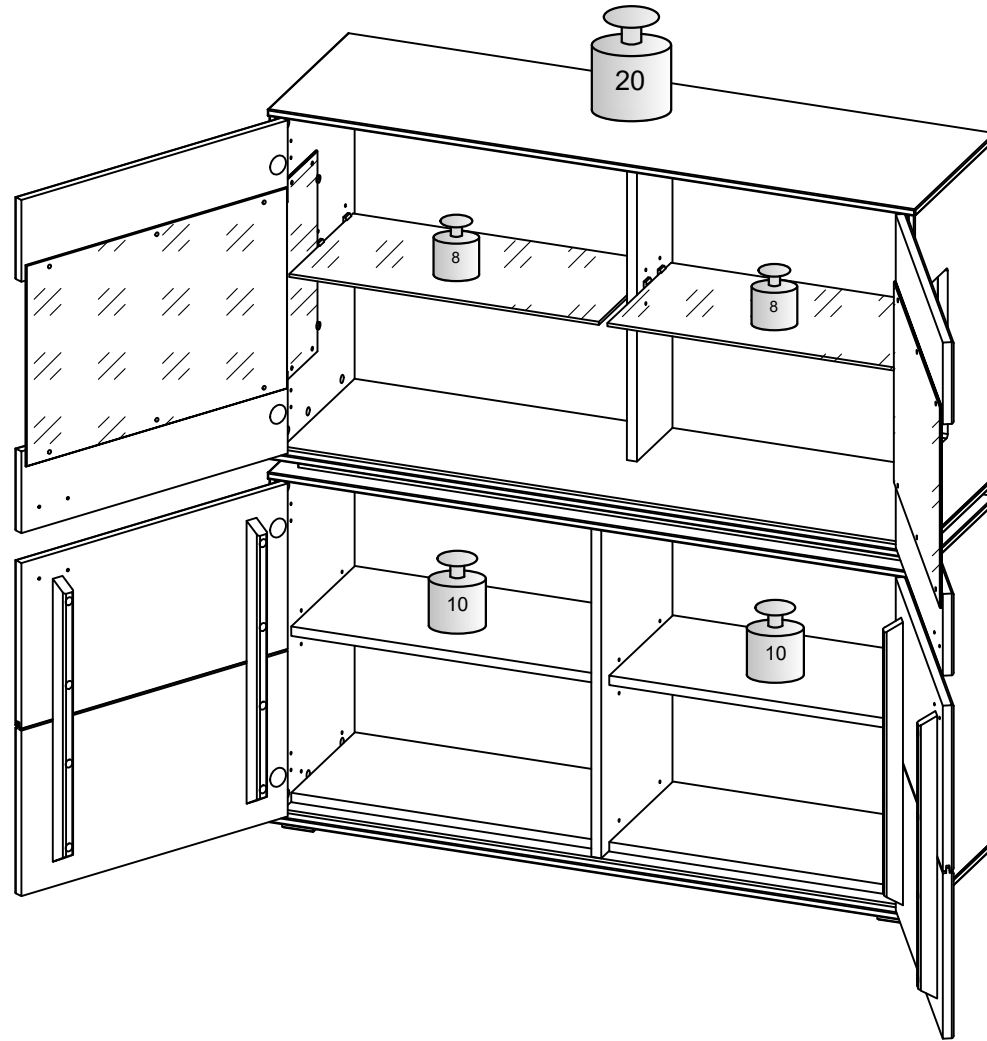

max. 20 kg



max. 10 kg



max. 8 kg

Modellname: **COMO**

MONTAGEANLEITUNG

TYPE T05 - HIGHBOARD

3/4

OPTIONAL BELEUCHTUNG!



2 Person

20
Min.

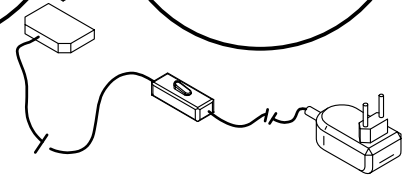
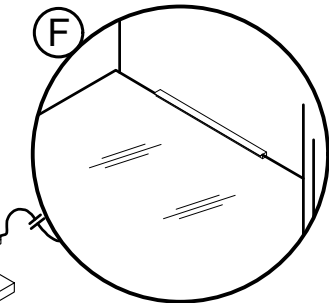
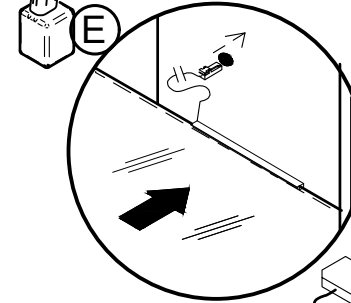
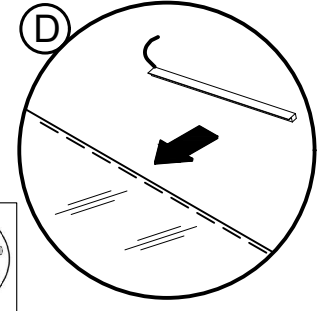
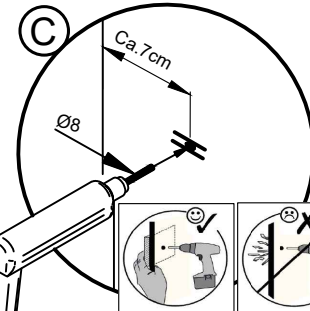
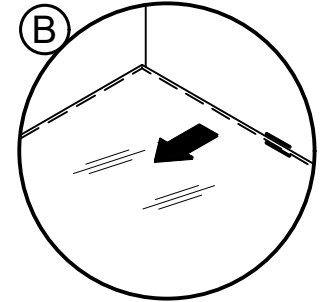
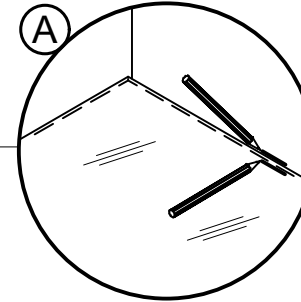
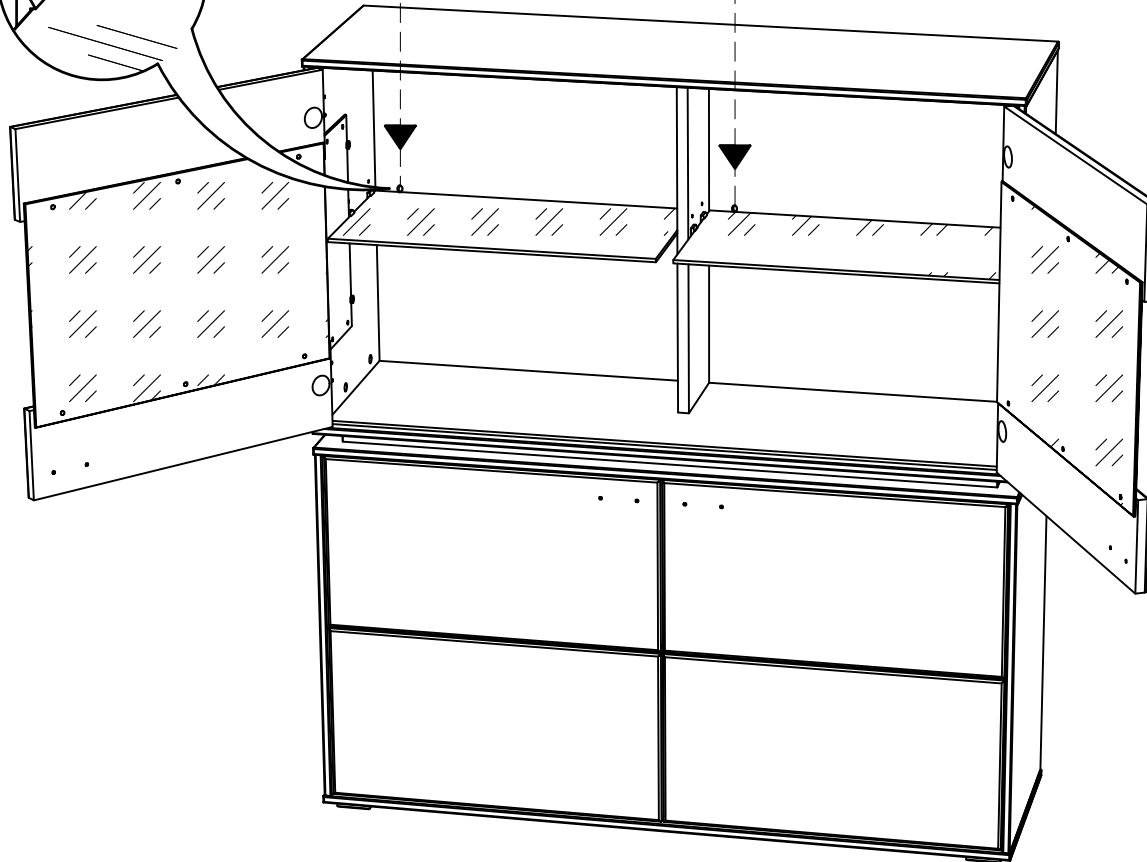
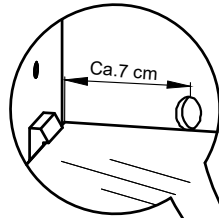
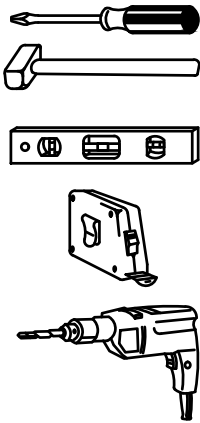

OPTION

05062ZB_Trafo	05062ZB_LED	005091ZB
x1	x1	x1

Modellname: **COMO**

MONTAGEANLEITUNG

TYPE T05 - HIDHBOARD

4/4

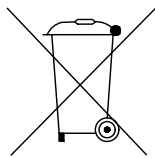

Das Symbol der durchgekreuzten Mülltonne bedeutet, dass elektrische sowie elektronische Teile nicht mit dem Hausmüll entsorgt werden dürfen. Bitte alle elektrischen/elektronischen Teile wie in der Aufbauanleitung gezeigt abmontieren und getrennt entsorgen.

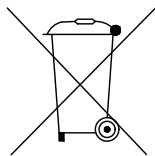

The crossed-out bin means that this product includes electrical and electronic pieces that must not be disposed of in the regular domestic waste. Please remove all electric/electronic equipment as described in the AI and dispose separately.

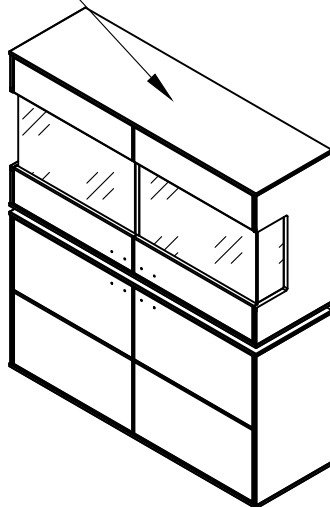

Achtung:



Beleuchtung!!

