

Instruction of installation of the bed

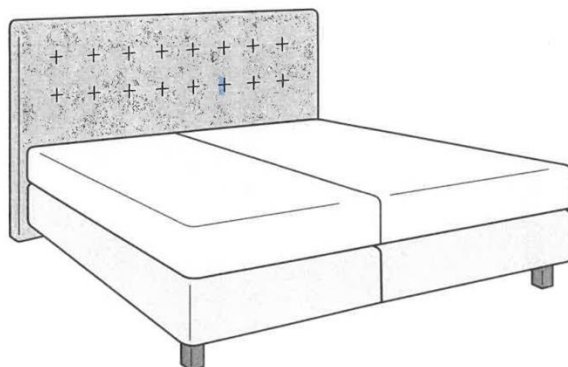

Step 1: remove packaging of the boxsprings and put them on the ground, with underside facing upwards

Step 2: put the feet on the boxsprings

There are 10 possible positions to put 6 feet.

When the beds are next to each other, the decorative feet can be placed on the 4 outer corners of the double bed. (see drawing)

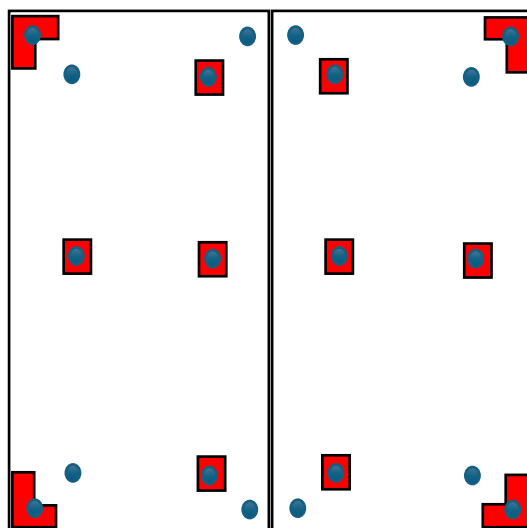

The support feet can be placed in a way that they are barely invisible.

The support feet in the middle of the bed are mandatory !

Step 3: install the connecting piece between the boxsprings

When the boxsprings are on the floor, the metal hinges are always foreseen on the HEADBOARD side of the bed. (red squares on the drawing). The boxsprings need to be arranged in a way that the metal hinges are positioned on the outside of the bed.

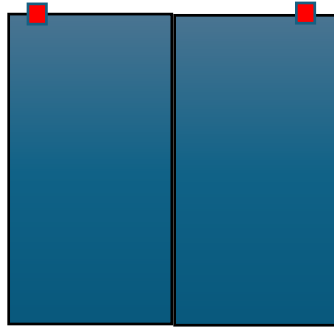

The connector between the boxsprings needs to be fixated at the FEET side of the bed. It is important that both pieces are placed at the same distance from the outer edge of the feet side of the bed.

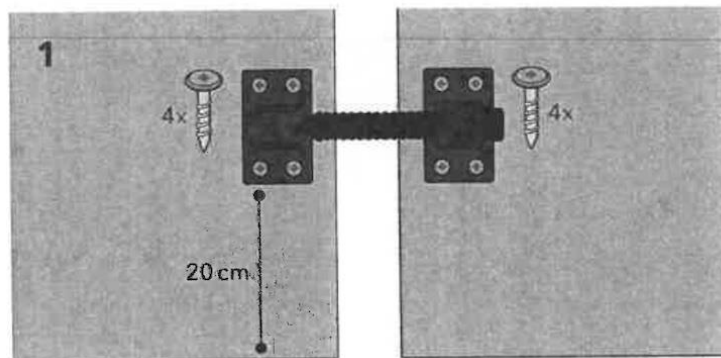

This is the way it should look:

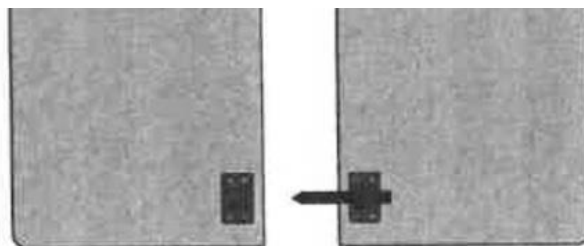

After the feet and the connecting piece are installed, the boxsprings need to be turned.

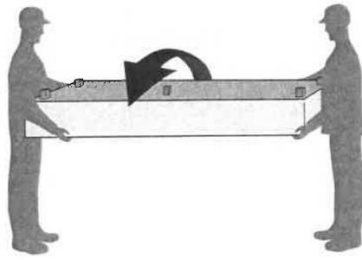

When the beds are in the right position, they can be slid next to each other and stay connected with the mounted connector piece.

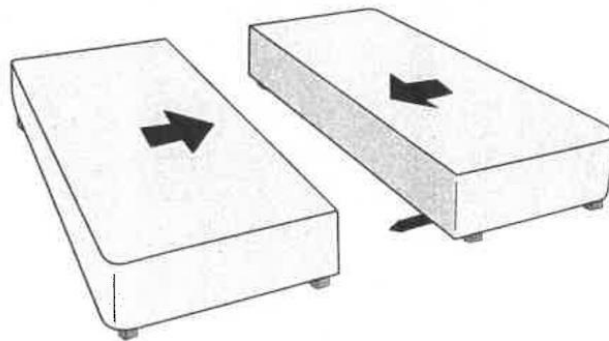

Step 4: install the headboard

The headboard comes with premounted hinges.

These hinges slide into the hinges that are mounted on the boxsprings.

The headboard should be installed by 2 people, each on one side of the bed.

To ensure a smooth installation, the headboard needs to be slid down, always keeping the upper side horizontally. The wedge-form of the hinges ensure a correct and noise-free fitting.

